

20 003 000 **SENTOSA PILLAR TAP**

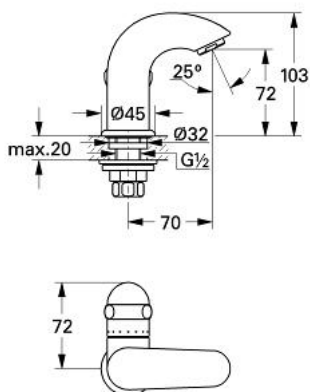

PRODUCT DESCRIPTION

- Colour: chrome
- Carbodur ceramic headpart 1/2", 180°
- fastened cast spout with mousseur
- with small handle
- marking: blue
- GROHE Long-Life finish



20 003 000 SENTOSA PILLAR TAP

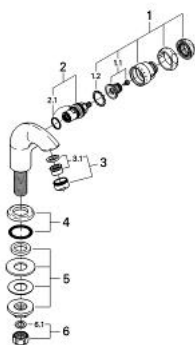

SPARE PARTS, January 1993 – now

- 1: Handle (Spare part-nr. 45550IP0)
- 1.1: Replacement handle connection kit (Spare part-nr. 45186000)
- 1.1.1: O-ring $\varnothing 18.2 \times \varnothing 1.7$ (Spare part-nr. 0392400M)
- 1.2: Guide ring (Spare part-nr. 0202100M)
- 2: Ceramic headpart, 1/2" (Spare part-nr. 45346000)
- 2.1: O-ring $\varnothing 18.2 \times \varnothing 1.7$ (Spare part-nr. 0392400M)
- 3: Mousseur (Spare part-nr. 13929000)
- 3.1: Repl.kit f.Mousseur M22x1 and M24x1 (Spare part-nr. 45002000)
- 4: Escutcheon (Spare part-nr. 45552000)
- 5: Shank mounting kit (Spare part-nr. 45553000)
- 6: Coupling nut 1/2" x 10.5 mm (Spare part-nr. 1290100M)
- 6.1: Fibre seal dia. 12x2 mm (Spare part-nr. 0138900M)