

20 094 000 ATLANTA PILLAR TAP

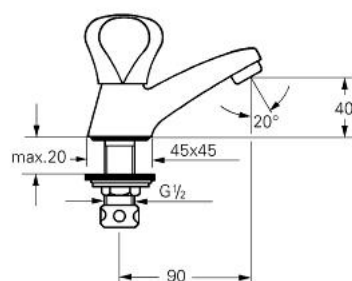

PRODUCT DESCRIPTION

- Colour: chrome
- ceramic headpart
- Treflor handle
- mousseur
- marking: blue/red
- union nut with 10.5 mm drilling
- GROHE Long-Life finish



20 094 000 ATLANTA PILLAR TAP

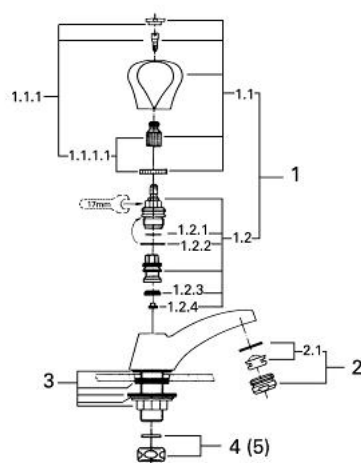

20.094

SPARE PARTS, January 1981 – now

- 1: Headpart 1/2" (Spare part-nr. 11086000)
- 1.1: Treflor handle blue/red (Spare part-nr. 45124000)
- 1.1.1: Handle fixation (Spare part-nr. 45123000)
- 1.1.1.1: Repl. kit f.handle fastening (Spare part-nr. 0538600M)
- 1.2: Headpart 1/2" (Spare part-nr. 07146000)
- 1.2.1: O-ring $\varnothing 6 \times \varnothing 2$ (Spare part-nr. 0128300M)
- 1.2.2: O-ring $\varnothing 18.2 \times \varnothing 1.7$ (Spare part-nr. 0392400M)
- 1.2.3: Ball seal dia. 9x6.8 mm (Spare part-nr. 0529100M)
- 2: Mousseur (Spare part-nr. 13929000)
- 2.1: Repl.kit f.Mousseur M22x1 and M24x1 (Spare part-nr. 45002000)
- 3: Shank fastening assembly (Spare part-nr. 45000000)
- 4: Coupling nut 1/2" x 10.5 mm (Spare part-nr. 1290100M)
- 4.1: Fibre seal dia. 12x2 mm (Spare part-nr. 0138900M)
- 5: Coupling nut 1/2" x 14.5 mm (Spare part-nr. 1290200M)
- 5.1: Fibre seal dia. 12x2 mm (Spare part-nr. 0138900M)