

20 147 000 **ARIA 3-HOLE BASIN MIXER**

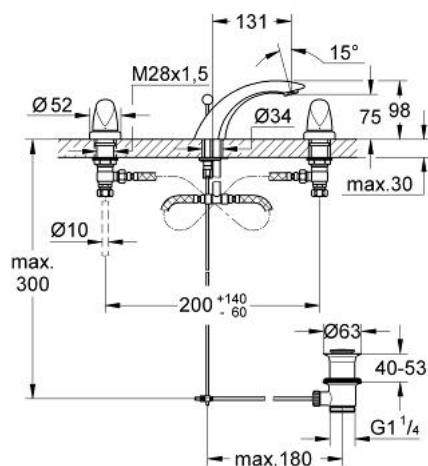

PRODUCT DESCRIPTION

- Colour: chrome
- Carbodur ceramic headparts 1/2", 180°
- non swivel spout with mousseur
- pressure-proof, flexible connection hoses between spout and side valves
- union nut with 10.5 mm drilling
- pop-up waste set 1 1/4"
- GROHE Long-Life finish

20 147 000 ARIA 3-HOLE BASIN MIXER

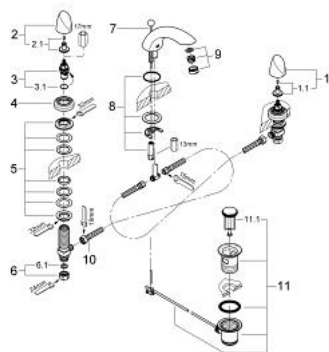

SPARE PARTS, June 2006 – now

- 1: Handle (Spare part-nr. 45980000)
- 1.1: Replacement handle connection kit (Spare part-nr. 45605000)
- 2: Handle (Spare part-nr. 45972000)
- 2.1: Replacement handle connection kit (Spare part-nr. 45605000)
- 3: Ceramic headpart, 1/2" (Spare part-nr. 45346000)
- 3.1: O-ring $\varnothing 18.2 \times \varnothing 1.7$ (Spare part-nr. 0392400M)
- 4: Escutcheon (Spare part-nr. 04698000)
- 5: Shank fastening assembly (Spare part-nr. 45025000)
- 6: Coupling nut 1/2" x 10.5 mm (Spare part-nr. 1290100M)
- 6.1: Fibre seal dia. 12x2 mm (Spare part-nr. 0138900M)
- 7: Pop-up rod (Spare part-nr. 07511000)
- 8: Shank mounting kit (Spare part-nr. 46122000)
- 9: Mousseur (Spare part-nr. 13929000)
- 10: Flexible hose (Spare part-nr. 45442000)
- 11: Pop-up waste set (Spare part-nr. 28915000)
- 11.1: Plug (Spare part-nr. 45210000)