

20 190 000 ALLURE 3-HOLE BASIN MIXER S-SIZE

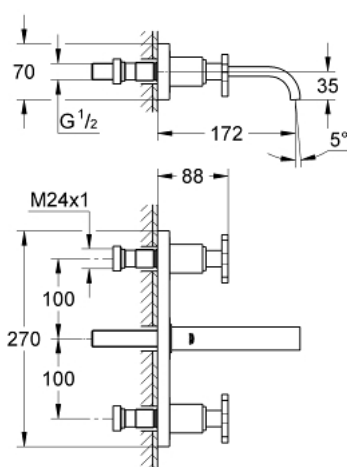

PRODUCT DESCRIPTION

- Colour: chrome
- wall mounted
- without concealed body
- set for final installation for
- 32 706 000
- with metal plate
- valves hot/cold with Carbidur ceramic headparts 1/2" - 180°
- GROHE Long-Life finish
- flow limiter 8 l/min.
- spout with mousseur
- centre distance 200 mm
- projection 172 mm

20 190 000 **ALLURE 3-HOLE BASIN MIXER**
S-SIZE

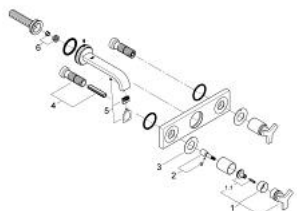

SPARE PARTS, September 2009 – now

- 1: Handle (Spare part-nr. 46611000)
- 1.1: Replacement handle connection kit (Spare part-nr. 45605000)
- 2: Extension (Spare part-nr. 45607000)
- 3: Sealing washer (Spare part-nr. 48046000)
- 4: Extension 20-80 (Spare part-nr. 45202000)
- 5: Mousseur (Spare part-nr. 13220000)
- 6: Flow restrictor (Spare part-nr. 46324000)