

20 216 001 **CONCETTO 3-HOLE BASIN MIXER** **L-SIZE**

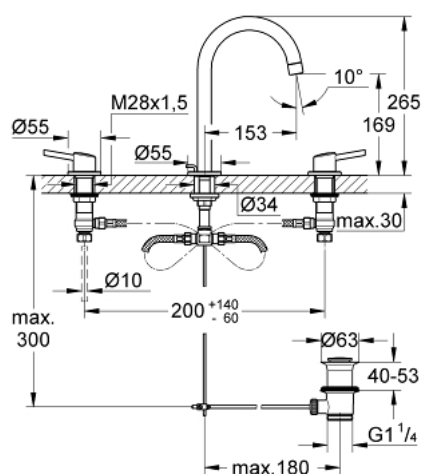

PRODUCT DESCRIPTION

- Colour: chrome
- ceramic headpart 1 1/2", 90°
- GROHE Long-Life finish
- GROHE FastFixation installation system with centering support
- spout with mousseur
- pop-up waste set 1 1/4"
- pressure-proof, flexible connection hoses between middle-body and side valves
- union nut with 10.5 mm drilling



20 216 001 **CONCETTO 3-HOLE BASIN MIXER** **L-SIZE**

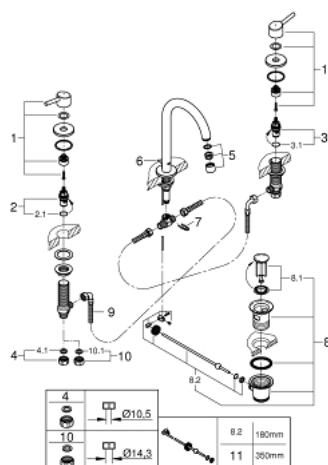

SPARE PARTS, February 2019 – now

- 1: Handle pair (Spare part-nr. 48310000)
- 2: Ceramic headpart, 1/2" (Spare part-nr. 45882000)
- 2.1: O-ring $\varnothing 18.2 \times \varnothing 1.7$ (Spare part-nr. 0392400M)
- 3: Ceramic headpart, 1/2" (Spare part-nr. 45883000)
- 3.1: O-ring $\varnothing 18.2 \times \varnothing 1.7$ (Spare part-nr. 0392400M)
- 4: Coupling nut 1/2" x 10.5 mm (Spare part-nr. 1290100M)
- 4.1: Fibre seal dia. 12x2 mm (Spare part-nr. 0138900M)
- 5: Mousseur (Spare part-nr. 06574000)
- 6: Pop-up rod (Spare part-nr. 65196000)
- 7: Fixing clamp (Spare part-nr. 6554100M)
- 8: Pop-up waste set 1 1/4" (Spare part-nr. 28910000)
- 8.1: Plug (Spare part-nr. 07182000)
- 8.2: Eccentric rod (Spare part-nr. 07052000)
- 9: Flexible connection hose (Spare part-nr. 45704000)
- 10: Coupling nut 1/2" x 14.5 mm (Spare part-nr. 1290200M)*
- 11: Eccentric rod (Spare part-nr. 07341000)*

* Optional accessories