

20 800 000 **SEABURY 3-HOLE BASIN MIXER**



PRODUCT DESCRIPTION

- Colour: chrome
- without handles
- cast spout with mousseur
- ceramic headparts 1/2", 90°
- pop-up waste set 1 1/4"
- pressure-proof, flexible connection hoses between spout and side valves
- for Seabury cross and lever handles 18 731 / 18 732
- GROHE Long-Life finish

20 800 000 SEABURY 3-HOLE BASIN MIXER

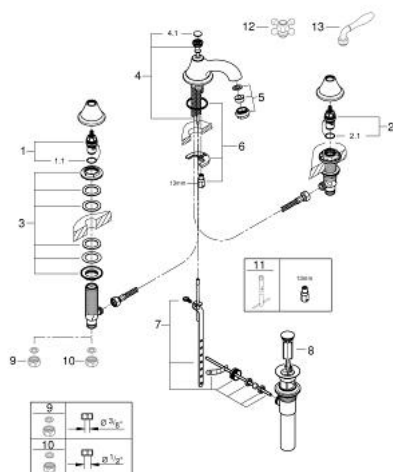

SPARE PARTS, July 2016 – spareParts.validDate.now

- 1: Ceramic headpart, 1/2" (Order-nr. 45882000)
 - 1.1: O-ring $\varnothing 18.2 \times \varnothing 1.7$ (Order-nr. 0392400M)
 - 2: Ceramic headpart, 1/2" (Order-nr. 45883000)
 - 2.1: O-ring $\varnothing 18.2 \times \varnothing 1.7$ (Order-nr. 0392400M)
 - 3: Shank fastening assembly (Order-nr. 45025000)
 - 4: Pop-up rod (Order-nr. 45766000)
 - 4.1: Marking piece (Order-nr. 45763L00)
 - 5: Flow straightener (Order-nr. 13931000)
 - 6: Shank mounting kit (Order-nr. 46249000)
 - 7: Ball rod (Order-nr. 48332000)
 - 8: Plug (Order-nr. 48331000)
 - 9: Coupling nut 1/2" x 10.5 mm (Order-nr. 1290100M)*
 - 10: Coupling nut 1/2" x 14.5 mm (Order-nr. 1290200M)*
 - 11: Mounting wrench (Order-nr. 19017000)*
 - 12: Sinfonia cross handles (Order-nr. 18731000)*
 - 13: Lever Handle (Order-nr. 18732000)*
- * Optional accessories