

20 800 BE0 **SEABURY 3-HOLE BASIN MIXER**



PRODUCT DESCRIPTION

- Colour: polished nickel
- without handles
- cast spout with mousseur
- ceramic headparts 1/2", 90°
- pop-up waste set 1 1/4"
- pressure-proof, flexible connection hoses between spout and side valves
- for Seabury cross and lever handles 18 731 / 18 732
- GROHE Long-Life finish

20 800 BE0 SEABURY 3-HOLE BASIN MIXER

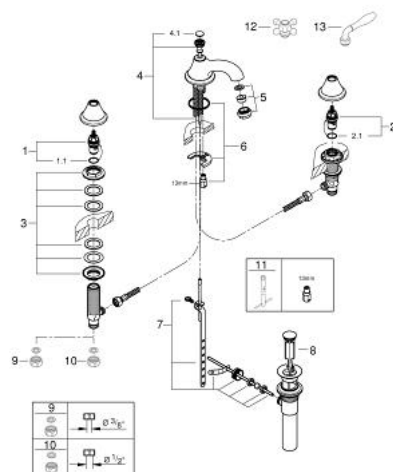

SPARE PARTS, July 2016 – spareParts.validDate.now

- 1: Ceramic headpart, 1/2" (Order-nr. 45882000)
- 1.1: O-ring $\varnothing 18.2 \times \varnothing 1.7$ (Order-nr. 0392400M)
- 2: Ceramic headpart, 1/2" (Order-nr. 45883000)
- 2.1: O-ring $\varnothing 18.2 \times \varnothing 1.7$ (Order-nr. 0392400M)
- 3: Shank fastening assembly (Order-nr. 45025000)
- 4: Pop-up rod (Order-nr. 45766BE0)
- 4.1: Marking piece (Order-nr. 45763L00)
- 5: Flow straightener (Order-nr. 13931BE0)
- 6: Shank mounting kit (Order-nr. 46249000)
- 7: Ball rod (Order-nr. 48332000)
- 9: Coupling nut 1/2" x 10.5 mm (Order-nr. 1290100M)*
- 10: Coupling nut 1/2" x 14.5 mm (Order-nr. 1290200M)*
- 11: Mounting wrench (Order-nr. 19017000)*
- 12: Sinfonia cross handles (Order-nr. 18731BE0)*
- 13: Lever Handle (Order-nr. 18732BE0)*

* Optional accessories