

## 20 892 000 **TALIA 3-HOLE BASIN MIXER**



### PRODUCT DESCRIPTION

- Colour: chrome
- GROHE Long-Life finish
- lever handles 18 077 000 & 18 077 EN0 (sold separately)
- without handles

## 20 892 000 TALIA 3-HOLE BASIN MIXER

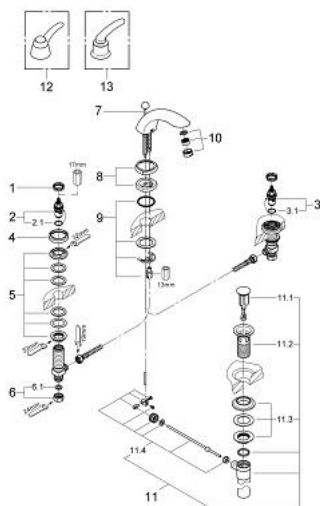

### SPARE PARTS, August 2009 – now

- 1: Ring (Spare part-nr. 03070000)
- 2: Ceramic headpart, 1/2" (Spare part-nr. 45882000)
- 2.1: O-ring  $\varnothing 18.2 \times \varnothing 1.7$  (Spare part-nr. 0392400M)
- 3: Ceramic headpart, 1/2" (Spare part-nr. 45883000)
- 3.1: O-ring  $\varnothing 18.2 \times \varnothing 1.7$  (Spare part-nr. 0392400M)
- 4: Escutcheon (Spare part-nr. 45822000)
- 5: Shank fastening assembly (Spare part-nr. 45025000)
- 6: Coupling nut 1/2" x 14.5 mm (Spare part-nr. 1290200M)
- 6.1: Fibre seal dia. 12x2 mm (Spare part-nr. 0138900M)
- 7: Pop-up rod (Spare part-nr. 45823000)
- 8: Escutcheon (Spare part-nr. 45825000)
- 9: Shank mounting kit (Spare part-nr. 46249000)
- 10: Flow straightener (Spare part-nr. 13955000)
- 11: Pop-up waste set (Spare part-nr. 28957000)
- 11.1: Plug (Spare part-nr. 45324000)
- 11.2: Housing (Spare part-nr. 01153000)
- 11.3: Ball rod (Spare part-nr. 45264000)
- 12: Talia lever handle (Spare part-nr. 18077000)\*
- 13: Talia metal handle, pair (Spare part-nr. 18085000)\*

\* Optional accessories