

20 892 EN0 **TALIA 3-HOLE BASIN MIXER**



PRODUCT DESCRIPTION

- Colour: brushed nickel
- GROHE Long-Life finish
- lever handles 18 077 000 & 18 077 EN0 (sold separately)
- without handles

20 892 EN0 TALIA 3-HOLE BASIN MIXER

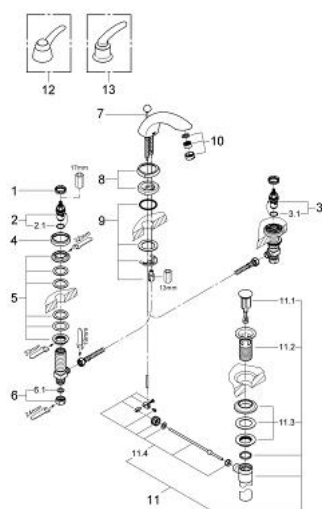

SPARE PARTS, August 2009 – spareParts.validDate.now

- 1: Ring (Order-nr. 03070000)
- 2: Ceramic headpart, 1/2" (Order-nr. 45882000)
- 2.1: O-ring $\varnothing 18.2 \times \varnothing 1.7$ (Order-nr. 0392400M)
- 3: Ceramic headpart, 1/2" (Order-nr. 45883000)
- 3.1: O-ring $\varnothing 18.2 \times \varnothing 1.7$ (Order-nr. 0392400M)
- 4: Escutcheon (Order-nr. 45822EN0)
- 5: Shank fastening assembly (Order-nr. 45025000)
- 6: Coupling nut 1/2" x 14.5 mm (Order-nr. 1290200M)
- 6.1: Fibre seal dia. 12x2 mm (Order-nr. 0138900M)
- 7: Pop-up rod (Order-nr. 45823EN0)
- 8: Escutcheon (Order-nr. 45825EN0)
- 9: Shank mounting kit (Order-nr. 46249000)
- 10: Flow straightener (Order-nr. 13955EN0)
- 11: Pop-up waste set (Order-nr. 28957EN0)
- 11.1: Plug (Order-nr. 45324EN0)
- 11.2: Housing (Order-nr. 01153EN0)
- 11.3: Ball rod (Order-nr. 45264000)
- 12: Talia lever handle (Order-nr. 18077EN0)*
- 13: Talia metal handle, pair (Order-nr. 18085EN0)*

* Optional accessories