

21 105 000 SENTOSA SINGLE-HOLE BASIN MIXER

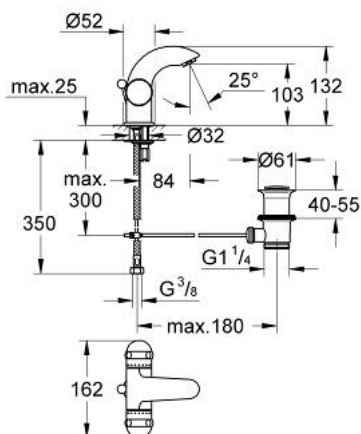

PRODUCT DESCRIPTION

- Colour: chrome
- Carbodur ceramic headparts 1/2", 180°
- fastened cast spout with mousseur
- pop-up waste set 1 1/4"
- flexible connection hoses
- rapid installation system
- min. recommended pressure 1.0 bar
- GROHE Long-Life finish



21 105 000 SENTOSA SINGLE-HOLE BASIN MIXER

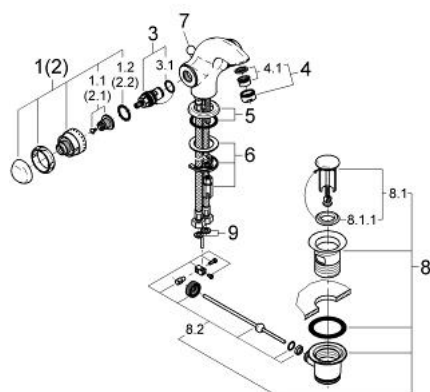

SPARE PARTS, January 1993 – now

- 1: Sentosa handle 1/2" red (Spare part-nr. 45539IP0)
- 1.1: Replacement handle connection kit (Spare part-nr. 45186000)
- 1.1.1: O-ring $\varnothing 18.2 \times \varnothing 1.7$ (Spare part-nr. 0392400M)
- 1.2: Guide ring (Spare part-nr. 0202100M)
- 2: Sentosa handle 1/2" (Spare part-nr. 45538IP0)
- 2.1: Replacement handle connection kit (Spare part-nr. 45186000)
- 2.2: Guide ring (Spare part-nr. 0202100M)
- 3: Ceramic headpart, 1/2" (Spare part-nr. 45346000)
- 3.1: O-ring $\varnothing 18.2 \times \varnothing 1.7$ (Spare part-nr. 0392400M)
- 4: Mousseur (Spare part-nr. 13929000)
- 4.1: Repl.kit f.Mousseur M22x1 and M24x1 (Spare part-nr. 45002000)
- 5: Escutcheon (Spare part-nr. 45540000)
- 6: Shank mounting kit (Spare part-nr. 46249000)
- 7: Pop-up rod (Spare part-nr. 45541P00)
- 8: Pop-up waste set 1 1/4" (Spare part-nr. 28910000)
- 8.1: Plug (Spare part-nr. 07182000)
- 8.2: Eccentric rod (Spare part-nr. 07052000)
- 9: Fibre seal $\varnothing 14.5 \times \varnothing 8 \times 2$ (Spare part-nr. 0138300M)