

25 011 000 **ATRIO BATH/SHOWER MIXER**

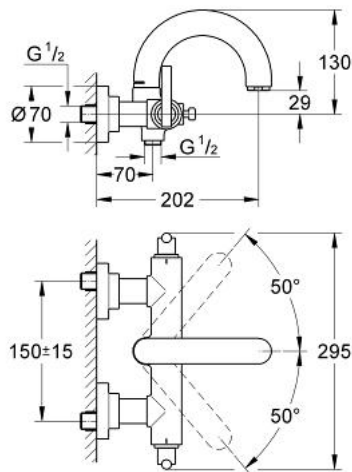

PRODUCT DESCRIPTION

- Colour: chrome
- wall mounted
- ceramic headparts 1/2", 90°
- automatic diverter: bath/shower
- swivel tubular spout with stop limiter
- mousseur
- integrated non-return valves in the shower outlet 1/2"
- covered S-unions
- protected against backflow
- with Jota handle
- without shower set
- GROHE Long-Life finish

25 011 000 ATRIO BATH/SHOWER MIXER

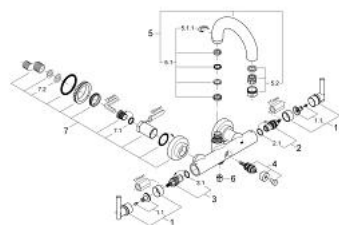

SPARE PARTS, November 2007 – now

- 1: Handle Jota (Spare part-nr. 45609000)
- 1.1: Replacement handle connection kit (Spare part-nr. 45605000)
- 2: Ceramic headpart, 1/2" (Spare part-nr. 45882000)
- 2.1: O-ring $\varnothing 18.2 \times \varnothing 1.7$ (Spare part-nr. 0392400M)
- 3: Ceramic headpart, 1/2" (Spare part-nr. 45883000)
- 3.1: O-ring $\varnothing 18.2 \times \varnothing 1.7$ (Spare part-nr. 0392400M)
- 4: Diverter (Spare part-nr. 45592000)
- 5: Spout (Spare part-nr. 45601000)
- 5.1: Repl.kit f.cast spout (Spare part-nr. 45474000)
- 5.1.1: Safety washer (Spare part-nr. 0585000M)
- 5.2: Mousseur (Spare part-nr. 13927000)
- 6: Non-return valve (Spare part-nr. 08565000)
- 7: Screw joint (Spare part-nr. 45631000)
- 7.1: O-ring $\varnothing 17 \times \varnothing 2$ (Spare part-nr. 0305500M)
- 7.2: Ball seal dia. 9x6.8 mm (Spare part-nr. 0138600M)