

## 25 085 000 AVINA BATH/SHOWER MIXER

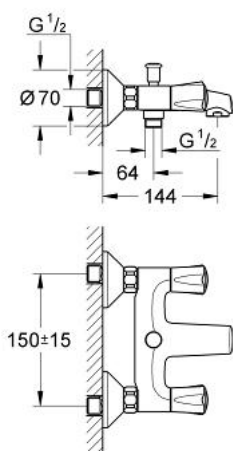

### PRODUCT DESCRIPTION

- Colour: chrome
- wall mounted
- metal handles
- heat-insulated
- screwable
- Carbodur headpart
- automatic diverter: bath/shower
- mousseur
- S-unions
- GROHE Long-Life finish

## 25 085 000 AVINA BATH/SHOWER MIXER

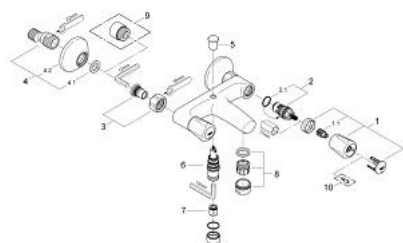

### SPARE PARTS, June 2007 – now

- 1: handle Atlanta (Spare part-nr. 45993000)
  - 1.1: Repl. kit f.handle fastening (Spare part-nr. 0538600M)
  - 2: Ceramic headpart, 1/2" (Spare part-nr. 45346000)
  - 2.1: O-ring  $\varnothing 18.2 \times \varnothing 1.7$  (Spare part-nr. 0392400M)
  - 3: Screw joint (Spare part-nr. 45544000)
  - 4: S-union (Spare part-nr. 12075000)
  - 4.1: Ball seal dia. 9x6.8 mm (Spare part-nr. 0138600M)
  - 4.2: Escutcheon (Spare part-nr. 0221000M)
  - 5: Diverter knob (Spare part-nr. 65648000)
  - 6: Diverter (Spare part-nr. 65655000)
  - 7: Non-return valve (Spare part-nr. 08565000)
  - 8: Mousseur (Spare part-nr. 13927000)
  - 9: Extension 3/4", 20 mm (Spare part-nr. 0713000M)\*
  - 10: Screw for Costa/Avina products (Spare part-nr. 48013000)\*
- \* Optional accessories