

25 561 000 TALIA BATH/SHOWER MIXER

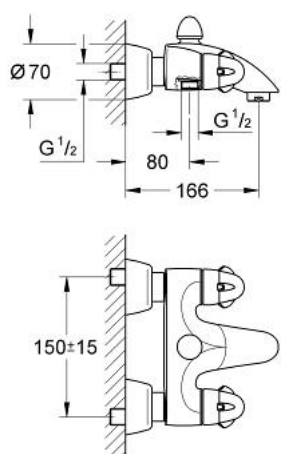

PRODUCT DESCRIPTION

- Colour: chrome
- wall mounted
- Carbodur ceramic headparts 1/2", 180°
- automatic diverter: bath/shower
- integrated non-return valves
- mousseur
- S-unions
- GROHE Long-Life finish

25 561 000 TALIA BATH/SHOWER MIXER

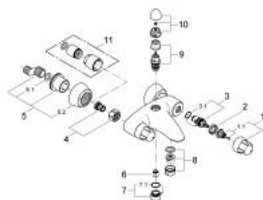

SPARE PARTS, July 2007 – now

- 1: Handle (Spare part-nr. 453571P0)
 - 1.1: Replacement handle connection kit (Spare part-nr. 45186000)
 - 1.1.1: O-ring $\varnothing 18.2 \times \varnothing 1.7$ (Spare part-nr. 0392400M)
 - 2: Ring (Spare part-nr. 03070000)
 - 3: Ceramic headpart, 1/2" (Spare part-nr. 45346000)
 - 3.1: O-ring $\varnothing 18.2 \times \varnothing 1.7$ (Spare part-nr. 0392400M)
 - 4: Screw joint (Spare part-nr. 45582000)
 - 5: S-union (Spare part-nr. 12058000)
 - 5.1: Ball seal dia. 9x6.8 mm (Spare part-nr. 0138600M)
 - 5.2: Covering escutcheon (Spare part-nr. 45545000)
 - 6: Non-return valve (Spare part-nr. 08565000)
 - 7: Outlet nipple (Spare part-nr. 45546000)
 - 7.1: O-ring $\varnothing 21 \times \varnothing 2$ (Spare part-nr. 0599900M)
 - 8: Mousseur (Spare part-nr. 13927000)
 - 9: Diverter (Spare part-nr. 08915000)
 - 10: Diverter knob (Spare part-nr. 45547000)
 - 11: Extension set 1/2", 30 mm (Spare part-nr. 46238000)*
- * Optional accessories