

26 011 000 **AVINA SHOWER MIXER**

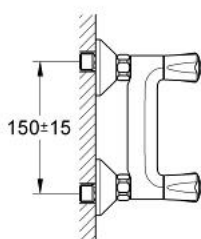
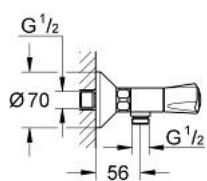

PRODUCT DESCRIPTION

- Colour: chrome
- wall mounted
- metal handles
- heat-insulated
- screwable
- Carbodur headpart
- shower connection 1/2"
- S-unions
- GROHE Long-Life finish

26 011 000 AVINA SHOWER MIXER

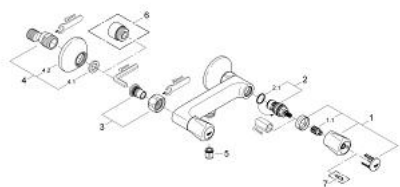

SPARE PARTS, June 2007 – now

- 1: handle Atlanta (Spare part-nr. 45993000)
- 1.1: Repl. kit f.handle fastening (Spare part-nr. 0538600M)
- 2: Ceramic headpart, 1/2" (Spare part-nr. 45346000)
- 2.1: O-ring $\varnothing 18.2 \times \varnothing 1.7$ (Spare part-nr. 0392400M)
- 3: Screw joint (Spare part-nr. 45544000)
- 4: S-union (Spare part-nr. 12075000)
- 4.1: Ball seal dia. 9x6.8 mm (Spare part-nr. 0138600M)
- 4.2: Escutcheon (Spare part-nr. 0221000M)
- 5: Non-return valve (Spare part-nr. 08565000)
- 6: Extension 3/4", 20 mm (Spare part-nr. 0713000M)*
- 7: Screw for Costa/Avina products (Spare part-nr. 48013000)*

* Optional accessories