

26 347 000 **SENTOSA SHOWER MIXER**

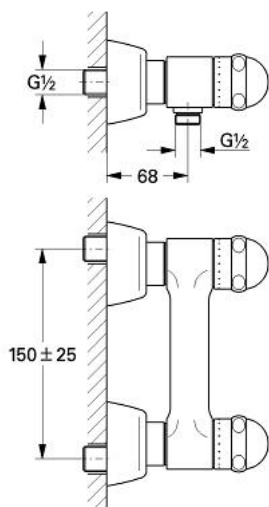

PRODUCT DESCRIPTION

- Colour: chrome
- wall mounted
- Carbodur ceramic headparts 1/2", 180°
- shower outlet 1/2"
- integrated non-return valve
- S-unions
- without shower set
- GROHE Long-Life finish

26 347 000 SENTOSA SHOWER MIXER

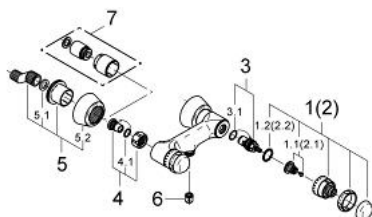

SPARE PARTS, January 1993 – now

- 1: Sentosa handle 1/2" (Spare part-nr. 45538IP0)
 - 1.1: Replacement handle connection kit (Spare part-nr. 45186000)
 - 1.1.1: O-ring $\varnothing 18.2 \times \varnothing 1.7$ (Spare part-nr. 0392400M)
 - 1.2: Guide ring (Spare part-nr. 0202100M)
 - 2: Sentosa handle 1/2" red (Spare part-nr. 45539IP0)
 - 2.1: Replacement handle connection kit (Spare part-nr. 45186000)
 - 2.2: Guide ring (Spare part-nr. 0202100M)
 - 3: Ceramic headpart, 1/2" (Spare part-nr. 45346000)
 - 3.1: O-ring $\varnothing 18.2 \times \varnothing 1.7$ (Spare part-nr. 0392400M)
 - 4: Screw joint (Spare part-nr. 45544000)
 - 4.1: Seal dia. 15x2 mm (Spare part-nr. 0311900M)
 - 5: S-union (Spare part-nr. 12058000)
 - 5.1: Ball seal dia. 9x6.8 mm (Spare part-nr. 0138600M)
 - 5.2: Covering escutcheon (Spare part-nr. 45545000)
 - 6: Non-return valve (Spare part-nr. 08565000)
 - 7: Extension set 1/2", 30 mm (Spare part-nr. 46238000)*
- * Optional accessories