

## 27 030 000 RAINSHOWER SYSTEM 210 SHOWER SYSTEM WITH GROHCLICK WITHOUT FITTING FOR WALL MOUNTING

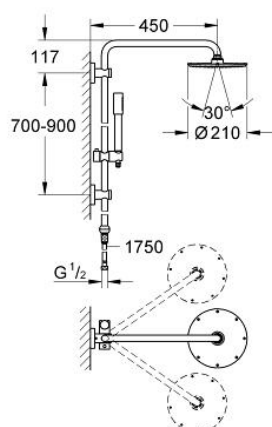

### PRODUCT DESCRIPTION

- Colour: chrome
- consisting of:
  - horizontal swivable 450 mm shower arm
  - change between hand and head shower by Grohclick element
  - Rainshower Cosmopolitan 210 metal head shower (28 368 000)
  - with ball joint
  - rotation angle  $\pm 20^\circ$
  - Sena hand shower (28 034 000)
  - adjustable in height with gliding element (12 140 000)
- connection to water supply with 1/2"-thread of the 800 mm shower hose to faucet / wall union
- metal shower hose 1750 mm (27 178)
- distance between wall supports: 700-900 mm
- minimum flow rate 7 l/min.
- GROHE DreamSpray perfect spray pattern
- GROHE Long-Life finish
- SpeedClean anti-lime system
- Inner WaterGuide for a longer life
- suitable for instantaneous heaters from 18 kW/h



## 27 030 000 RAINSHOWER SYSTEM 210 SHOWER SYSTEM WITH GROHCLICK WITHOUT FITTING FOR WALL MOUNTING

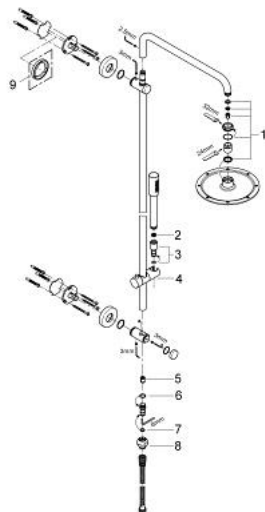

### SPARE PARTS, March 2007 – now

- 1: Inlet valve assembly (Spare part-nr. 45933000)
- 2: Dirt strainer (Spare part-nr. 0700200M)
- 3: Nipple for Freehander (Spare part-nr. 03720000)
- 4: Sliding piece (Spare part-nr. 12140000)
- 5: Non-return valve (Spare part-nr. 08565000)
- 6: Seat washer (Spare part-nr. 0128200M)
- 7: O-ring  $\varnothing 11 \times \varnothing 2$  (Spare part-nr. 0122400M)
- 8: Snap coupling (Spare part-nr. 45899000)
- 9: Compensation disc (Spare part-nr. 27180000)\*

\* Optional accessories