

27 038 000 RAINSHOWER SYSTEM 210 SHOWER SYSTEM WITH GROHCLICK WITHOUT FITTING FOR WALL MOUNTING

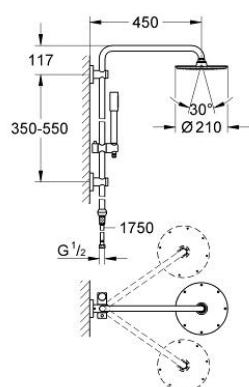

PRODUCT DESCRIPTION

- Colour: chrome
- consisting of:
 - horizontal swivable 450 mm shower arm
 - Rainshower Cosmopolitan 210 metal head shower (28 368 000)
 - ball joint with turning angle $20^\circ \pm 20^\circ$
 - Sena hand shower (28 034 000)
 - adjustable in height with gliding element (12 140 000)
 - connection to water supply with 1/2"-thread of the metal shower hose to faucet / wall union
 - change between hand and head shower by Grohclick element
 - distance between wall supports: 350-550 mm
 - suitable for instantaneous heaters from 18 kW/h
 - minimum flow rate 7 l/min.
 - GROHE Long-Life finish



27 038 000 RAINSHOWER SYSTEM 210 SHOWER SYSTEM WITH GROHCLICK WITHOUT FITTING FOR WALL MOUNTING

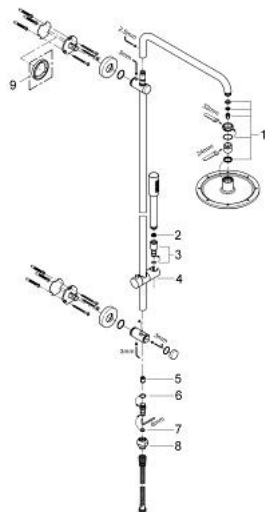

SPARE PARTS, January 2007 – now

- 1: Inlet valve assembly (Spare part-nr. 45933000)
- 2: Dirt strainer (Spare part-nr. 0700200M)
- 3: Nipple for Freehander (Spare part-nr. 03720000)
- 4: Sliding piece (Spare part-nr. 12140000)
- 5: Non-return valve (Spare part-nr. 08565000)
- 6: Seat washer (Spare part-nr. 0128200M)
- 7: O-ring $\varnothing 11 \times \varnothing 2$ (Spare part-nr. 0122400M)
- 8: Snap coupling (Spare part-nr. 45899000)
- 9: Compensation disc (Spare part-nr. 27180000)*

* Optional accessories