

## 27 433 000 RAINSHOWER ICON SYSTEM 190 SHOWER SYSTEM

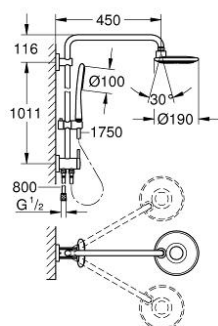

### PRODUCT DESCRIPTION

- Colour: chrome
- consisting of:
  - horizontal swivable 450 mm shower arm
  - change between hand and head shower by diverter
  - head shower Icon (27 439 000)
  - chrome plated spray plate
  - with ball joint
  - rotation angle  $\pm 15^\circ$
  - hand shower Icon 100 (27 377 000)
  - adjustable in height with gliding element (12 140 000)
  - 9.5 l/min. flow limiter
  - connection to water supply with 1/2"-thread of the 800 mm shower hose to faucet / wall union
  - Silverflex shower hose 1750 mm 1/2" x 1/2" (28 388 000)
  - minimum flow rate 7 l/min.
  - GROHE Water Saving - Less water, perfect flow
  - GROHE DreamSpray perfect spray pattern
  - GROHE Long-Life finish
  - SpeedClean anti-lime system
  - suitable for instantaneous heaters from 18 kW/h



## 27 433 000 RAINSHOWER ICON SYSTEM 190 SHOWER SYSTEM

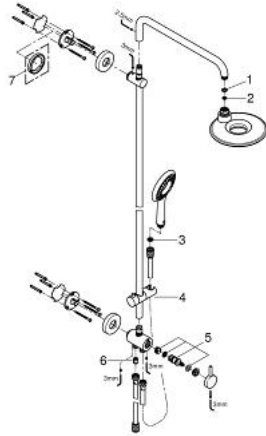

### SPARE PARTS, November 2009 – now

- 1: Fibre seal dia. 12x2 mm (Spare part-nr. 0138900M)
- 2: Dirt strainer (Spare part-nr. 48007000)
- 3: Dirt strainer (Spare part-nr. 0700200M)
- 4: Sliding piece (Spare part-nr. 12140000)
- 5: Repl.kit f.rotary valve (Spare part-nr. 45915000)
- 6: Non-return valve (Spare part-nr. 08565000)
- 7: Compensation disc (Spare part-nr. 27180000)\*

\* Optional accessories