

28 009 000 **MOVARIO 100 FIVE SHOWER RAIL SET 5 SPRAYS**

PRODUCT DESCRIPTION

- Colour: chrome
- consisting of:
- hand shower Five (28 393)
- shower rail 600 mm
- Rotaflex TwistStop shower hose 1.750 mm 1/2" x 1/2" (28 410)
- tray (28 549 000)
- Inner WaterGuide for a longer life
- GROHE Long-Life finish
- GROHE FastFixation Plus adjustable distance between brackets for adaption to existing drilling holes

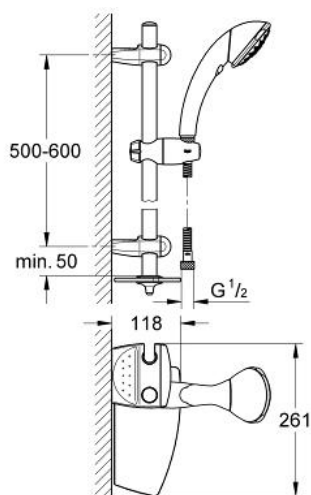

28 009 000 **MOVARIO 100 FIVE SHOWER RAIL SET 5 SPRAYS**

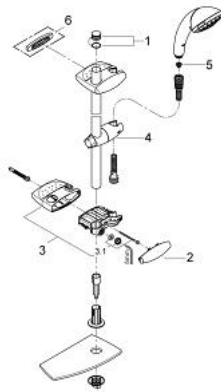

SPARE PARTS, June 2007 – now

1: Cap (Spare part-nr. 45922000)

2: Cap (Spare part-nr. 11482000)

3: Bracket (Spare part-nr. 45923000)

3.1: Fixing set (Spare part-nr. 45924000)

4: Sliding piece (Spare part-nr. 12353000)

5: Dirt strainer (Spare part-nr. 0676800M)

6: Compensation disc (Spare part-nr. 28407000)*

* Optional accessories