

29 052 000 **CONCEALED VALVE 1/2"**

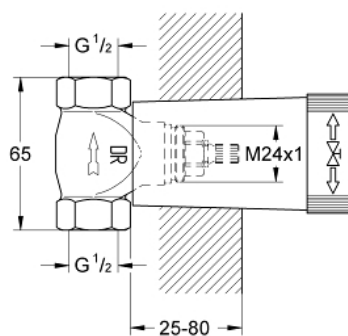

29 052 000 **CONCEALED VALVE 1/2"**

SPARE PARTS, January 1997 – now

1: Ceramic headpart, 1/2" (Spare part-nr. 45882000)

1.1: O-ring $\varnothing 18.2 \times \varnothing 1.7$ (Spare part-nr. 0392400M)

2: Seat (Spare part-nr. 45023000)

