

33 553 000 EUROPLUS SINGLE-LEVER BATH/SHOWER MIXER

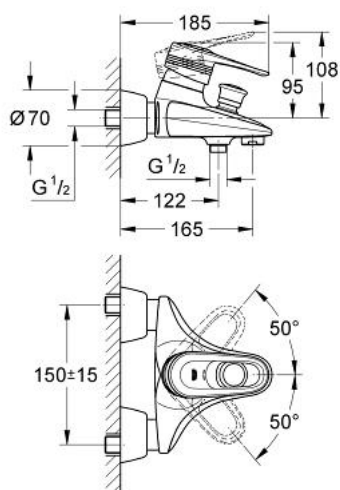

PRODUCT DESCRIPTION

- Colour: chrome
- wall mounted
- GROHE SilkMove 46 mm ceramic cartridge
- adjustable flow rate limiter
- adjustable minimum flow rate approx. 2.5 l/min
- automatic diverter: bath/shower
- mousseur
- integrated non-return valve in the shower outlet 1/2"
- covered S-unions
- covered lever fixing
- optional temperature limiter ref. no. 46 308
- without shower set
- GROHE Long-Life finish

33 553 000 EUROPLUS SINGLE-LEVER BATH/SHOWER MIXER

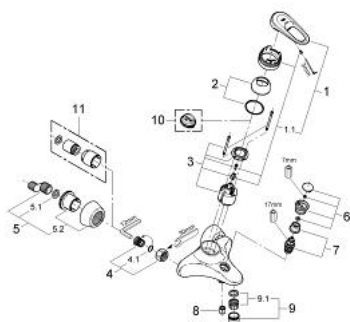

SPARE PARTS, January 1998 – now

- 1: Lever (Spare part-nr. 46415IP0)
- 1.1: Replacement handle connection kit (Spare part-nr. 46416IP0)
- 2: Shield (Spare part-nr. 46417000)
- 3: Cartridge (Spare part-nr. 46048000)
- 4: Screw joint (Spare part-nr. 45044000)
- 4.1: Seal dia. 15x2 mm (Spare part-nr. 0311900M)
- 5: S-union (Spare part-nr. 12058000)
- 5.1: Ball seal dia. 9x6.8 mm (Spare part-nr. 0138600M)
- 5.2: Covering escutcheon (Spare part-nr. 45545000)
- 6: Diverter knob (Spare part-nr. 46419IP0)
- 7: Diverter (Spare part-nr. 08915000)
- 8: Non-return valve (Spare part-nr. 08565000)
- 9: Mousseur (Spare part-nr. 13927000)
- 9.1: Repl.kit f.aerator M28x1 (Spare part-nr. 45029000)
- 10: Temperature limiter (Spare part-nr. 46308000)*
- 11: Extension set 1/2", 30 mm (Spare part-nr. 46238000)*

* Optional accessories