

33 708 SD1 ZEDRA SINGLE-LEVER SINK MIXER 1/2"

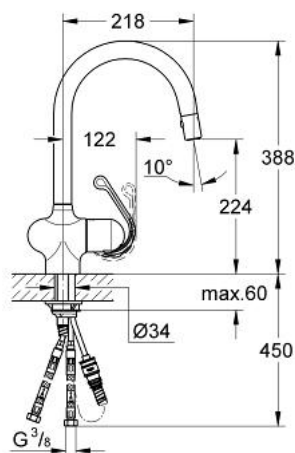

PRODUCT DESCRIPTION

- Colour: stainless steel
- single hole installation
- GROHE SilkMove 46 mm ceramic cartridge
- GROHE Long-Life finish
- GROHE RealSteel product material (stainless steel body)
- adjustable flow rate limiter
- swivel tubular spout
- extractable trigger spray Dual integrated
- automatic diverter:
- mousseur/hand shower
- returning help
- integrated non-return valves
- flexible connection hoses
- rapid installation system
- protected against backflow
- mousseur height 224 mm
- spout height 388 mm

33 708 SD1 ZEDRA SINGLE-LEVER SINK MIXER 1/2"

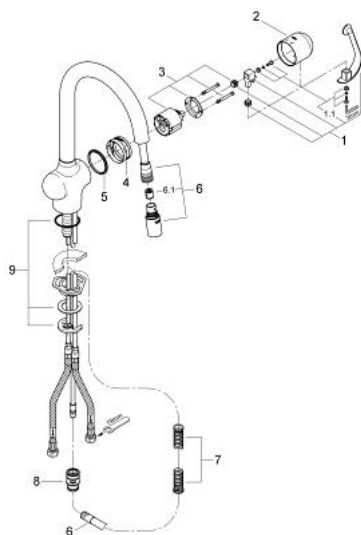

SPARE PARTS, March 2007 – now

- 1: Lever (Spare part-nr. 46309000)
- 1.1: Fixing set (Spare part-nr. 46310000)
- 2: Cap (Spare part-nr. 46311000)
- 3: Cartridge (Spare part-nr. 46048000)
- 4: Guide ring (Spare part-nr. 0538000M)
- 5: Sliding ring (Spare part-nr. 04954V0M)
- 6: Hand shower (Spare part-nr. 46592DC0)
- 6.1: Non-return valve (Spare part-nr. 08565000)
- 6.2: Flow straightener (Spare part-nr. 13997000)
- 7: Compression spring (Spare part-nr. 07240000)
- 8: Snap coupling (Spare part-nr. 46338000)
- 9: Shank mounting kit (Spare part-nr. 46345000)