

33 961 000 **SINGLE-LEVER MIXER, CONCEALED BODY**

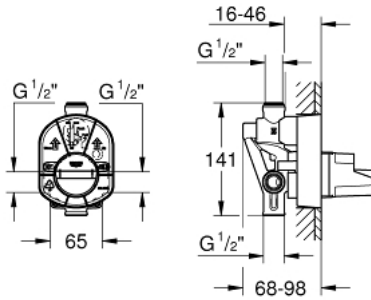

PRODUCT DESCRIPTION

- for bath and shower
- without finishing trim set
- wall installation
- GROHE SilkMove 46 mm ceramic cartridge
- adjustable flow rate limiter
- top and bottom outlet 1/2"
- cap included
- diverter in set for final installation
- clockwise thread
- fastening loops



33 961 000 **SINGLE-LEVER MIXER, CONCEALED BODY**

SPARE PARTS, January 1994 – now

1: Cartridge (Spare part-nr. 46048000)

