

34 282 000 COMFORT SET GROHTHERM 2000



PRODUCT DESCRIPTION

- Colour: chrome
- consisting of:
- Grotherm 2000 set for final installation (19 354)
- GROHE SafeStop at 38°C
- volume handle with GROHE EcoButton (economy button with individually adjustable economy stop)
- Carbodur ceramic headpart 1/2", 180°
- metal escutcheon
- covered coupling
- GROHE Rapido T thermostatic mixer for concealed installation (35 500 000)
- installation depth 70 - 95 mm
- easy to install, premounted and tested unit
- GROHE TurboStat compact cartridge with wax thermoelement
- body of DR brass
- built-in non return valves
- Rainshower Cosmopolitan shower set with GROHE DreamSpray
- shower rail, 900 mm (28 819 001)
- GROHE FastFixation Plus (adjustable distance between wall shower holders for adaption to existing drillings)
- hand shower Cosmopolitan (28 756 000)
- 4 spray patterns:
- Rain, Jet, Pure, Champagne spray
- SpeedClean anti-lime system
- Silverflex shower hose 1750 mm (28 388 000)
- TwistStop to prevent hose from twisting
- shower outlet elbow (28 626)
- GROHE Water Saving - Less water, perfect flow
- GROHE Long-Life finish

34 282 000 COMFORT SET GROHTHERM 2000

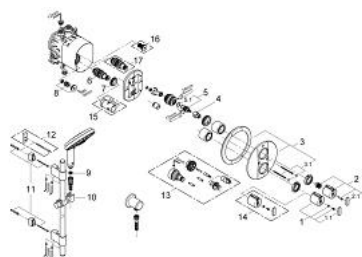

SPARE PARTS, October 2007 – spareParts.validDate.now

- 1: Scale handle (Order-nr. 47742000)
- 1.1: Cap (Order-nr. 1007500M)
- 2: Handle for shut-off valve with economy device (Order-nr. 47745000)
- 2.1: Cap (Order-nr. 1007500M)
- 3: Escutcheon (Order-nr. 47749000)
- 3.1: Set of screws (Order-nr. 46088000)
- 4: Temperature limiter (Order-nr. 10093000)
- 5: Ceramic headpart, 1/2" (Order-nr. 45346000)
- 5.1: O-ring $\varnothing 18.2 \times \varnothing 1.7$ (Order-nr. 0392400M)
- 6: Thermostatic compact cartridge 3/4" (Order-nr. 47483000)
- 7: Fitting ring (Order-nr. 47765000)
- 8: Non-return valve (Order-nr. 47753000)
- 9: Dirt strainer (Order-nr. 0700200M)
- 10: Sliding piece (Order-nr. 06765000)
- 11: Fixing set (Order-nr. 45403000)
- 12: Compensation disc (Order-nr. 45914VT0)*
- 13: Extension-set, 27,5 mm (Order-nr. 47780000)*
- 14: Scale handle (Order-nr. 47286000)*
- 15: Socket spanner (Order-nr. 19332000)*
- 16: Safety combination (DIN EN 1717) (Order-nr. 29007000)*
- 17: Thermostatic compact cartridge 3/4" (Order-nr. 47186000)*

* Optional accessories