

## 35 500 000 GROHE RAPIDO T THERMOSTATIC MIXER FOR CONCEALED INSTALLATION

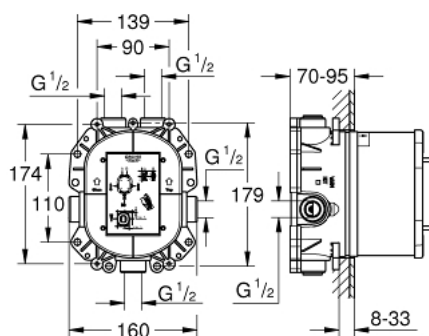

### PRODUCT DESCRIPTION

- for use with Grohtherm Special and Grohtherm F
- without finishing trim set
- flat installation depth 70 - 95 mm
- easy to install, premounted and tested unit
- GROHE TurboStat compact cartridge with wax thermoelement
- two top outlets 1/2", lockable
- high flow rate up to 50 l/min. by use of three outlets
- bottom outlet 1/2" can be used only with separate stop valve
- safe to install, stable built-in-box and protective cap
- fixation options for solid walls and dry cladding
- material for wall sealing included
- Aquadimmer-diverter for bath mixer or stop valve for shower mixer in finishing trim set
- body of DR brass
- built-in non return valves and dirt strainers
- GROHE Water Saving - Less water, perfect flow
- min. recommended pressure 1.0 bar



## 35 500 000 GROHE RAPIDO T THERMOSTATIC MIXER FOR CONCEALED INSTALLATION

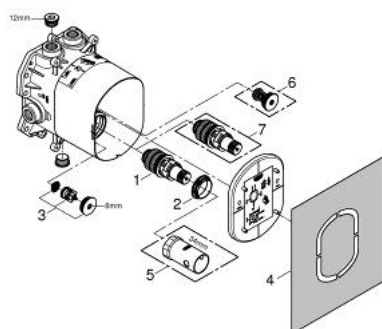

### SPARE PARTS, November 2005 – now

- 1: Thermostatic compact cartridge 3/4" (Spare part-nr. 47483000)
  - 2: Fitting ring (Spare part-nr. 47765000)
  - 3: Non-return valve (Spare part-nr. 47753000)
  - 4: Repl. kit f. seal (Spare part-nr. 48263000)
  - 5: Socket spanner (Spare part-nr. 19332000)\*
  - 6: Safety combination (DIN EN 1717) (Spare part-nr. 29007000)\*
  - 7: Thermostatic compact cartridge 3/4" (Spare part-nr. 47186000)\*
- \* Optional accessories