

36 088 000 ESSENCE E INFRA-RED ELECTRONIC BASIN MIXER 1/2" WITH MIXING DEVICE AND ADJUSTABLE TEMPERATURE LIMITER

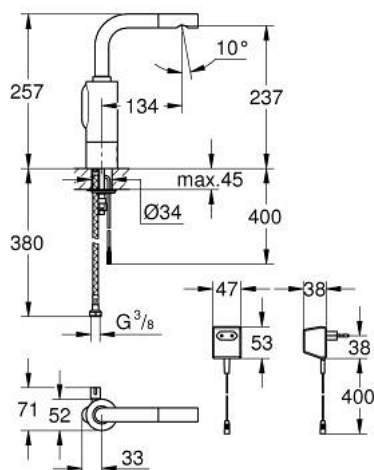

PRODUCT DESCRIPTION

- Colour: chrome
- single hole installation
- with plug transformer 230 V, 50 Hz, 3,2 VA
- GROHE Long-Life finish
- GROHE Water Saving 5.0 l/min. flow limiter
- integrated mousseur
- solenoid valve integrated in housing
- flexible connection hoses
- dirt strainers
- rapid installation system
- automatic safety stop after 60 sec. (factory set)
- additional functions and precise settings by remote control 36 407
- automatic flushing after 1 or 3 days without use
- activation of permanent run for thermal disinfection for 3.5 or 11 min
- CE approved
- acoustic group I in accordance with DIN 4109
- type of protection faucet IP 59K



36 088 000 ESSENCE E INFRA-RED ELECTRONIC BASIN MIXER 1/2" WITH MIXING DEVICE AND ADJUSTABLE TEMPERATURE LIMITER

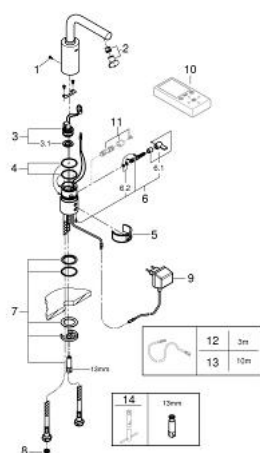

SPARE PARTS, June 2016 – now

- 1: Screw (Spare part-nr. 4283100M)
 - 2: Mousseur (Spare part-nr. 13943000)
 - 3: Solenoid valve (Spare part-nr. 43066000)
 - 3.1: Dirt Strainer (Spare part-nr. 42798000)
 - 4: Seat washer (Spare part-nr. 4283600M)
 - 5: Cleaning clip (Spare part-nr. 42837000)
 - 6: Lever (Spare part-nr. 42363000)
 - 6.1: Mixing lever (Spare part-nr. 42364000)
 - 6.2: Seat washer (Spare part-nr. 4284000M)
 - 7: Fixing set (Spare part-nr. 42841000)
 - 8: Filter (Spare part-nr. 4241300M)
 - 9: Plug transformer (Spare part-nr. 43016000)
 - 10: Remote control (Spare part-nr. 36407001)*
 - 11: Security cover cap (Spare part-nr. 36209000)*
 - 12: Extension cable (Spare part-nr. 36221000)*
 - 13: Extension cable (Spare part-nr. 36222000)*
 - 14: Mounting wrench (Spare part-nr. 19017000)*
- * Optional accessories