

36 143 000 PULSOMAT SURF RADAR-ELECTRONIC BASIN MIXER 1/2" WITH MIXING DEVICE

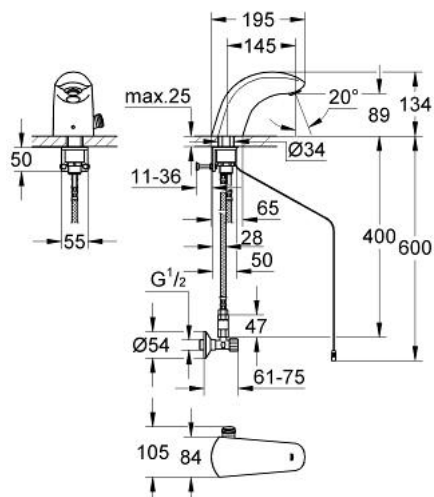

PRODUCT DESCRIPTION

- Colour: chrome
- single hole installation
- tap hole diameter 35 mm
- power supply 24 V
- CE approved
- solenoid valve
- flow limiter 6 l/min
- 2 flexible hoses
- dirt strainer
- non-return valve
- 2 angle valves
- without power supply unit
- rotation lock
- GROHE Long-Life finish

36 143 000 PULSOMAT SURF RADAR-ELECTRONIC BASIN MIXER 1/2" WITH MIXING DEVICE

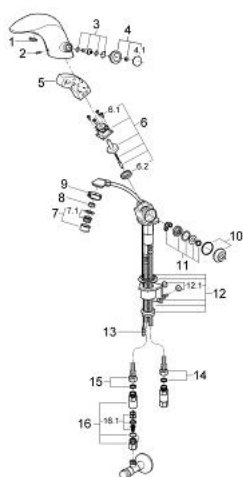

SPARE PARTS, January 1995 – now

- 1: Cap (Spare part-nr. 43411000)
- 2: Screw dia. 4x52 mm (Spare part-nr. 43093000)
- 3: Shaft (Spare part-nr. 43049000)
- 4: Mixing ring (Spare part-nr. 43096P00)
- 4.1: Cap (Spare part-nr. 43410000)
- 5: Electronic (Spare part-nr. 43673000)
- 6: Magnetic coil (Spare part-nr. 43635000)
- 6.1: Screw (Spare part-nr. 4308600M)
- 6.2: Membrane (Spare part-nr. 43737000)
- 7: Mousseur (Spare part-nr. 13929000)
- 7.1: Repl.kit f.Mousseur M22x1 and M24x1 (Spare part-nr. 45002000)
- 8: Flow restrictor (Spare part-nr. 43284000)
- 9: Ring (Spare part-nr. 43297000)
- 10: Cover (Spare part-nr. 43249000)
- 11: Cartridge (Spare part-nr. 43460000)
- 12: Rotation lock (Spare part-nr. 43926000)
- 12.1: Washer (Spare part-nr. 4307700M)
- 13: Cable (Spare part-nr. 43698000)
- 14: Hose cold (Spare part-nr. 43372000)
- 15: Hose warm (Spare part-nr. 43373000)
- 16: Non-return valve (Spare part-nr. 43431000)
- 16.1: Non-return valve (Spare part-nr. 42842000)