

36 240 000 EUROPLUS E INFRARED ELECTRONIC WASH BASIN THERMOSTAT, 1/2"

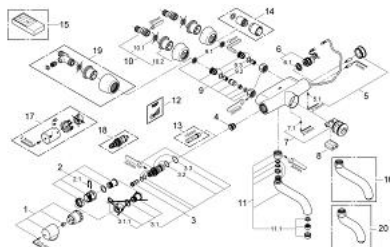

SPARE PARTS, June 2008 – now

- 1: Scale handle (Spare part-nr. 47409000)
 - 2: Stop ring (Spare part-nr. 47641000)
 - 2.1: Fixing clamp (Spare part-nr. 0574400M)
 - 3: Thermo-element 1/2" (Spare part-nr. 47217000)
 - 3.1: Stop ring + regulating nut (Spare part-nr. 47300000)
 - 3.1.1: Fixing clamp (Spare part-nr. 0574400M)
 - 3.2: O-ring $\varnothing 21 \times \varnothing 2$ (Spare part-nr. 0599900M)
 - 3.3: O-ring $\varnothing 24 \times \varnothing 2$ (Spare part-nr. 0119600M)
 - 4: Seat for thermostat (Spare part-nr. 01460000)
 - 5: Shield (Spare part-nr. 43384000)
 - 5.1: Screw dia. 4x52 mm (Spare part-nr. 4346200M)
 - 6: Solenoid valve (Spare part-nr. 42323000)
 - 6.1: Dirt Strainer (Spare part-nr. 42798000)
 - 7: Cartridge (Spare part-nr. 42130000)
 - 7.1: Screw dia. 4x52 mm (Spare part-nr. 4346200M)
 - 8: Battery (Spare part-nr. 42886000)
 - 9: Screw joint (Spare part-nr. 47643000)
 - 9.1: Dirt Strainer (Spare part-nr. 0726400M)
 - 9.2: Non-return valve (Spare part-nr. 08565000)
 - 9.3: O-ring $\varnothing 17 \times \varnothing 2$ (Spare part-nr. 0305500M)
 - 10: S-union (Spare part-nr. 12058000)
 - 10.1: Ball seal dia. 9x6.8 mm (Spare part-nr. 0138600M)
 - 10.2: Covering escutcheon (Spare part-nr. 45545000)
 - 11: Spout for Europlus E thermostat (Spare part-nr. 42133000)
 - 11.1: Flow straightener (Spare part-nr. 13960000)
 - 12: Sticker with pictograph (Spare part-nr. 4217800M)
 - 13: Socket spanner (Spare part-nr. 19070000)*
 - 14: Extension set 1/2", 30 mm (Spare part-nr. 46238000)*
 - 15: Infra-red remote control (Spare part-nr. 36206000)*
 - 16: Spout for Europlus E thermostat (Spare part-nr. 42132000)*
 - 17: Metal handle temperature control (Spare part-nr. 47763000)*
 - 18: Thermoelement for changed waterways (Spare part-nr. 47657000)*
 - 19: S-union (Spare part-nr. 12051000)*
 - 20: Spout for Europlus E thermostat (Spare part-nr. 43957000)*
- * Optional accessories

36 240 000 EUROPLUS E INFRARED ELECTRONIC WASH BASIN THERMOSTAT, 1/2"

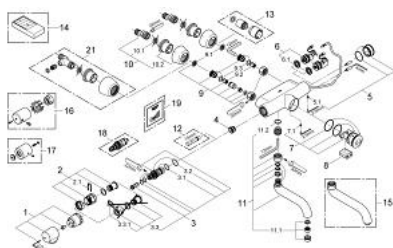

SPARE PARTS, January 2001 – June 2008

- 1: Scale handle (Spare part-nr. 47409000)
 - 1.1: Replacement handle connection kit (Spare part-nr. 47277000)
 - 2: Stop ring (Spare part-nr. 47641000)
 - 2.1: Fixing clamp (Spare part-nr. 0574400M)
 - 3: Thermo-element 1/2" (Spare part-nr. 47217000)
 - 3.1: Stop ring + regulating nut (Spare part-nr. 47300000)
 - 3.1.1: Fixing clamp (Spare part-nr. 0574400M)
 - 3.2: O-ring $\varnothing 21 \times \varnothing 2$ (Spare part-nr. 0599900M)
 - 3.3: O-ring $\varnothing 24 \times \varnothing 2$ (Spare part-nr. 0119600M)
 - 4: Seat for thermostat (Spare part-nr. 01460000)
 - 5: Shield (Spare part-nr. 43384000)
 - 5.1: Screw dia. 4x52 mm (Spare part-nr. 4346200M)
 - 6: Solenoid valve (Spare part-nr. 42892000)
 - 6.1: Membrane (Spare part-nr. 42835000)
 - 6.2: Dirt Strainer (Spare part-nr. 42798000)
 - 7: Cartridge (Spare part-nr. 42130000)
 - 7.1: Screw dia. 4x52 mm (Spare part-nr. 4346200M)
 - 8: Battery (Spare part-nr. 42886000)
 - 9: Screw joint (Spare part-nr. 47643000)
 - 9.1: Dirt Strainer (Spare part-nr. 0726400M)
 - 9.2: Non-return valve (Spare part-nr. 08565000)
 - 9.3: O-ring $\varnothing 17 \times \varnothing 2$ (Spare part-nr. 0305500M)
 - 10: S-union (Spare part-nr. 12051000)
 - 10.1: Ball seal dia. 9x6.8 mm (Spare part-nr. 0138600M)
 - 10.2: Escutcheon (Spare part-nr. 45392000)
 - 11: Spout for Europlus E thermostat (Spare part-nr. 42133000)
 - 11.1: Flow straightener (Spare part-nr. 13960000)
 - 12: Socket spanner (Spare part-nr. 19070000)*
 - 13: Extension set 1/2", 30 mm (Spare part-nr. 46238000)*
 - 14: Infra-red remote control (Spare part-nr. 36206000)*
 - 15: Flow straightener (Spare part-nr. 1395800M)*
 - 16: Spout for Europlus E thermostat (Spare part-nr. 42132000)*
 - 17: Scale handle, metallic (Spare part-nr. 47639000)*
 - 18: Socket spanner for thermostat (Spare part-nr. 47640000)*
 - 19: Thermoelement for changed waterways (Spare part-nr. 47657000)*
 - 20: Sticker with pictograph (Spare part-nr. 4217800M)*
- * Optional accessories