

36 242 SD0 EUROPLUS E INFRARED ELECTRONIC BASIN MIXER 1/2"



PRODUCT DESCRIPTION

- Colour: stainless steel
- set for final installation for concealed fitting box
- 36 009
- 36 241
- IR-electronic with detection in the handwashing area
- automatic safety stop after 60 sec. (factory set)
- transformer 230 V AC/12 AC (supply voltage to control)
- touch free cleaning mode for 3 minutes
- functions to activate with remote control 36 206 000:
- automatic flushing after 1 or 3 days without use
- activation of permanent run for thermal disinfection for 3.5 or 11 min
- stainless steel escutcheon
- stainless steel spout 245 mm
- laminar flow straightener 9 l/min.
- type of protection IP 54
- acoustic group I in accordance with DIN 4109
- CE approved
- GROHE Water Saving - Less water, perfect flow
- without concealed body

36 242 SD0 EUROPLUS E INFRARED ELECTRONIC BASIN MIXER 1/2"

SPARE PARTS, January 2009 – spareParts.validDate.now

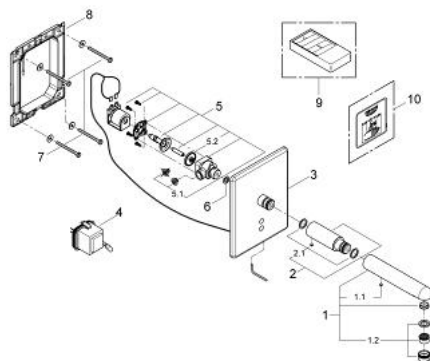

- 1: Spout (Order-nr. 42121SD0)
 - 1.1: Screw dia. 4x52 mm (Order-nr. 43094000)
 - 1.2: Flow straightener (Order-nr. 13960000)
 - 2: Outlet extension (Order-nr. 42126SD0)
 - 2.1: Screw dia. 4x52 mm (Order-nr. 43094000)
 - 3: Cover plate Europlus E incl.electronic (Order-nr. 42122SD0)
 - 4: Transformer (Order-nr. 42278000)
 - 5: Solenoid valve (Order-nr. 42123000)
 - 5.1: Dirt Strainer (Order-nr. 4215200M)
 - 5.2: Membrane (Order-nr. 43809000)
 - 6: Fibre seal dia. 12x2 mm (Order-nr. 0138900M)
 - 7: Fixing set (Order-nr. 4308500M)
 - 8: Frame (Order-nr. 42736000)
 - 9: Infra-red remote control (Order-nr. 36206000)*
 - 10: Sticker with pictograph (Order-nr. 4217700M)*
- * Optional accessories