

37 751 001 TECTRON RETRO-FIT UNIT



PRODUCT DESCRIPTION

- Colour: chrome
- with infrared sensor for bi-directional communication for monitoring, configuration and service purpose
- 6 V lithium battery, type CR-P2
- battery lifetime: approx. 7 years (150 actuations a day)
- exposed installation
- for concealed urinal flush valve 37 017 and DAL 509
- metal housing 145 x 90 x 45 mm
- solenoid valve with dirt strainer
- multistage battery status display
- 7 pre-set programs:
 - auto flush
 - cleaning mode
 - pre-flush on/off
- additional functions and precise settings by remote control 36 407
- adjustable flow time by hand or remote
- CE approved



37 751 001 TECTRON RETRO-FIT UNIT

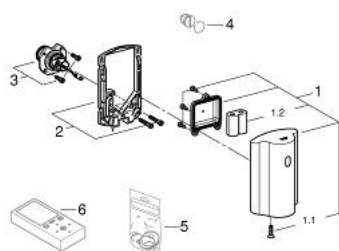

SPARE PARTS, March 2016 – now

- 1: Housing electronic f. 37751 (Spare part-nr. 42789000)
- 1.1: Fastening screw for 37751 (Spare part-nr. 42788000)
- 1.2: Battery (Spare part-nr. 42886000)
- 2: Mounting frame for 37751 (Spare part-nr. 42790000)
- 3: Solenoid valve with strainer for 37751 (Spare part-nr. 42791000)
- 4: Isolating valve (Spare part-nr. 43392000)*
- 5: Set of seals for 37751 (Spare part-nr. 42792000)*
- 6: Remote control (Spare part-nr. 36407001)*

* Optional accessories