

38 506 SP0 **SKATE AIR FLUSH PLATE**

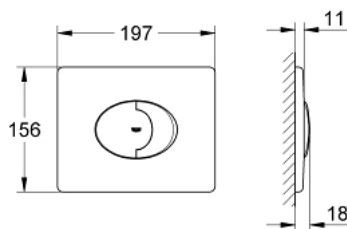

PRODUCT DESCRIPTION

- for dual flush or start & stop actuation
- for pneumatic discharge valve
- horizontal installation
- 156 x 197 mm
- material: ABS
- GROHE Water Saving - Less water, perfect flow



38 506 SP0 **SKATE AIR FLUSH PLATE**

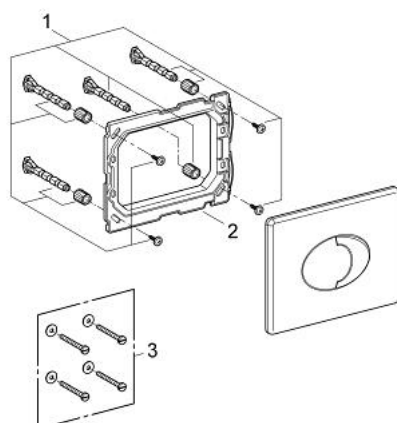

SPARE PARTS, June 2003 – now

1: Fixing set (Spare part-nr. 4215800M)

2: Frame (Spare part-nr. 43207000)

3: Fixing set (Spare part-nr. 4308500M)*

* Optional accessories