

## 38 766 KS0 **GROHE ONDUS WALL PLATE**

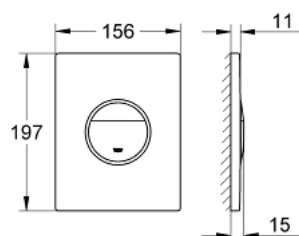

### PRODUCT DESCRIPTION

- Colour: velvet black
- for dual flush or start & stop actuation
- for pneumatic discharge valve AV1
- vertical and horizontal installation
- 156 x 197 mm
- made of ABS



## 38 766 KS0 **GROHE ONDUS WALL PLATE**

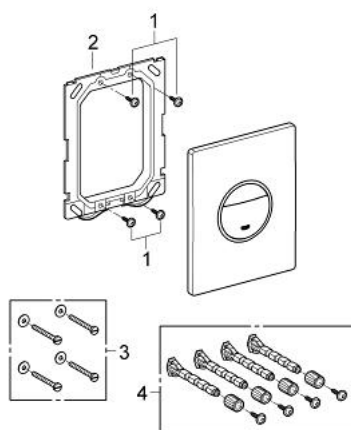

### **SPARE PARTS**, January 2014 – spareParts.validDate.now

1: Screw dia. 4x52 mm (Order-nr. 6636200M)

2: Frame (Order-nr. 43207000)

3: Fixing set (Order-nr. 4308500M)\*

4: Fixing set (Order-nr. 4215800M)\*

\* Optional accessories